

TERMINAL BLOCK Connector

PCB Series

KLS2-308V-2.54 Series Pitch=2.54mm

Electrical :

Rated voltage: 300V
 Rated current: 6A
 Contact resistance: 20mΩ
 Insulation resistance: 5000MΩ/1000V
 Withstanding Voltage: AC2000V/1Min
 Wire range: 26-18AWG 1.0mm²

Material

Screws: M1.5 steel Zinc plated
 Contact: Brass, Electroless nickel
 Pin header: Brass, Tin plated
 Housing: PA66, UL94V-0

Mechanical

Temp. Range: -40°C~+105°C
 MAX Soldering: +250°C for 5 Sec.
 Torque: 0.15Nm (1.3 lb.in)
 Strip length: 3.7-4.7mm

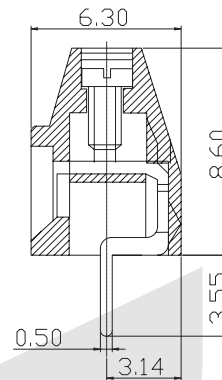
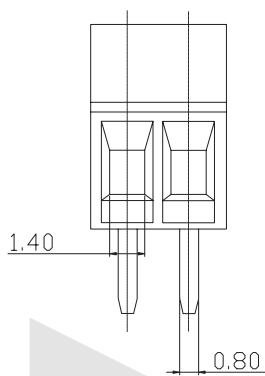
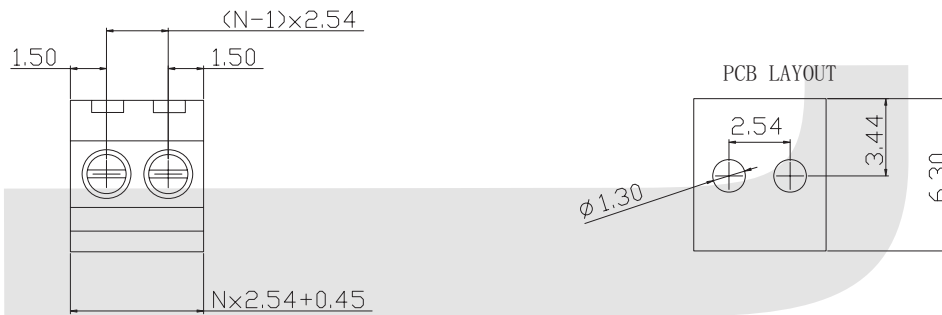

ORDER INFORMATION

Product No.: KLS2-308V-2.54-XXP-X X-X

Pos. No.	Customer Request
Series No.	Screw: C=Cross Screw S=Slot Screw
Pitch: 2.54=2.54mm	Color: 1=Gray 2=Blue 3=Black 4=Green 5=Orange 6=Red 7=Transparent 8=Yellow 9=White
Number of Pole	